

# Your Event

Every event is unique in its own special way. Various occasions and individual ideas need special attention. The Madison Hotel Hamburg is flexible in realizing your wishes professionally, with heart and soul and commitment. A discrete and reliable service is just as matter of course as is state-of-the-art equipment for every requirement. Five air-conditioned rooms can largely be connected creating the perfect ambience for every event. Nearly all the rooms are flooded by daylight and have a beautiful foyer. Our penthouses with spacious terraces and a grand view over the rooftops of Hamburg as well as our large suites offer the ideal setting for private, exclusive affairs. The Madison Hotel Hamburg appreciates your individual needs and turns your event into an experience for you and your guests.

We are looking forward to your visit. Tel +49 40 37666-140

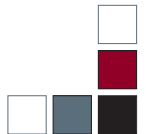

## Alster and Fleet

The event rooms Alster and Fleet have been designed with a versatile room concept and can be expanded to include the adjacent foyer and Marley's Restaurant. This additionally separated area with its own entrance allows you to personally greet guests and work without interruption.

Room	Daylight	Sizes		Chairs					
		Space	Length x Width / Height	Classroom	Theater	Banquet	Reception	U Shape	Block
Fleet	x	35 m <sup>2</sup>	5,3 m x 6,6 m / 2,8 m	20	30	20	40	16	16
Alster	x	80 m <sup>2</sup>	12,1 m x 6,6 m / 2,8 m	44	70	48	70	28	24
AlsterFleet	x	115 m <sup>2</sup>	17,4 m x 6,6 m / 2,8 m	80	120	80	110	45	30

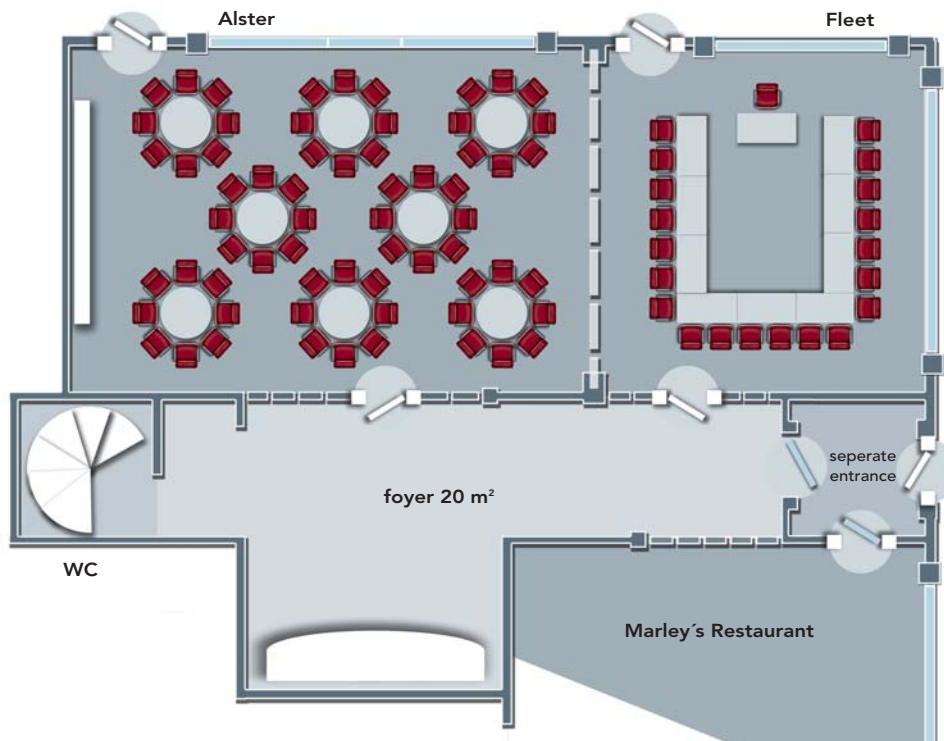

< **Standard conference technical equipment:**  
 sound system,  
 one flipchart,  
 one materials case for instructors,  
 one metaplan board,  
 one screen and one overhead projector,  
 writing pads and pens for every participant

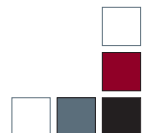

## Michel, Nikolai and Elbe

The rooms Michel and Nikolai can be connected and have an extra-ordinary gallery foyer with a view down into the lobby, as does the room Elbe. Two penthouses have a grand view out over Hamburg and the harbor. These and the eight suites impart the appropriate ambience for private affairs.

Room	Daylight	Sizes		Chairs					
		Space	Length x Width / Height	Classroom	Theater	Banquet	Reception	U Shape	Block
Michel	-	45 m <sup>2</sup>	7,5 m x 7,3 m / 2,5 m	18	30	16	30	15	15
Nikolai	-	35 m <sup>2</sup>	5,1 m x 7,3 m / 2,5 m	18	20	10	20	15	15
Elbe	x	65 m <sup>2</sup>	9,6 m x 6,6 m / 2,3 m	45	60	32	50	25	15

